

Installation of retrieval block on megapod:

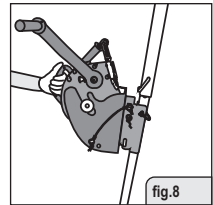
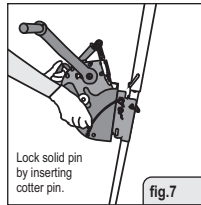
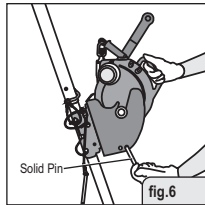
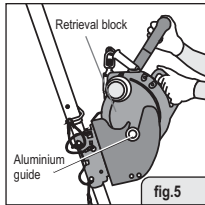
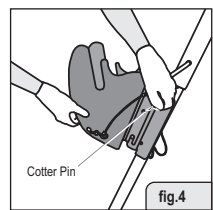
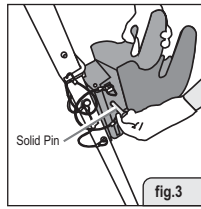
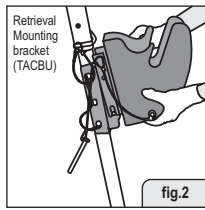
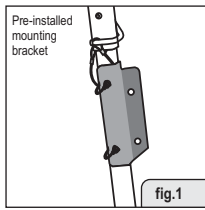

- STEP 1** Locate the megapod leg that has pre-installed mounting bracket for installing the retrieval block.
- STEP 2** Place the retrieval mounting bracket (TACBU) on the lower mounting bracket pre-installed on the megapod leg and insert the guiding pin into the slot. (refer fig. 2 and 3)
- STEP 3** Use solid pin for locking the Retrieval Mounting bracket(TACBU) on pre-installed mounting bracket of megapod leg. (refer fig. 4)
- STEP 4** Lock the solid pin on mounting brackets using cotter pin. (refer Fig. 4)
- STEP 5** Insert retrieval block in bracket guided by aluminum guide provided on both side of retrieval. (refer Fig. 5)
- STEP 6** Lock the anchorage eye with bracket followed by solid pin and lock solid pin from other end by inserting cotter pin. (refer fig. 6&7). Now the retrieval block is ready to be used on megapod (refer fig. 8)

OTHERS:

- **Maintenance & Cleaning:** Repairs to equipment can be made only by a FRONTLINE representative or person or entity authorized by FRONTLINE. Contact FRONTLINE for maintenance and repair. Cleaning after use is important for maintaining the safety and life of the equipment. Cleanse the equipment of all dirt, corrosives, and contaminants. If the equipment cannot simply be wiped clean use a mild soap and water. Rinse, wipe, and hang to dry in shade.
- **Storage:** Store the anchorage connector component harness in a cool, dry and clean place out of direct sunlight. Avoid areas where heat, moisture, light, oil, and chemicals or their vapors or other degrading elements may be present. Equipment which is damaged or in need of maintenance should not be stored in the same area as usable equipment. Heavily soiled, wet, or otherwise contaminated equipment should be properly maintained (e.g. dried and cleaned) prior to storage.
Prior to using equipment which has been stored for long periods of time, a Formal Inspection should be performed by a competent person. For harnesses with Dielectric buckles, pass-thru buckles or Quick Connect Buckles, store the harness with the buckles connected.
- **Training:** It is the responsibility of the users to assure that they read, understand, and follow all instructions and are trained in the care and use of this device. Training should be repeated periodically and any time there is a change of components within the system. Training must be conducted without exposing the trainee to a fall hazard